

4.0

# Professional Cablemanagement

New



Cable-Snake® Flex II

New



Cable-Snake® Cube MX

New



Cable-Snake® Premium Tex

New



E-Cube-M

New



Easy-Connect

New



Easy-Desk-3G, Easy-Steel

New



Easy-Cover & Easy Clip

New



Easy-Bridge



# Innovative Solutions for **Demanding** Consumers

**Cable-Snake®**  
*Professional Cablemanagement*



***Made in Germany***

**We have been supplying professional cable guiding systems for high quality office environments since 1994.**

Cable-Snake® cable guiding systems are highly innovative with excellent functionality and professional design. Because of the extensive range of accessories, applications are almost unlimited.

All Cable-Snake® systems are mutually compatible and 100% networkcapable!

We will be happy to advice you!



Cable-Snake® Cube



Cable-Snake® Premium



Cable-Snake® Pro



E-Cube-M Energy Tower

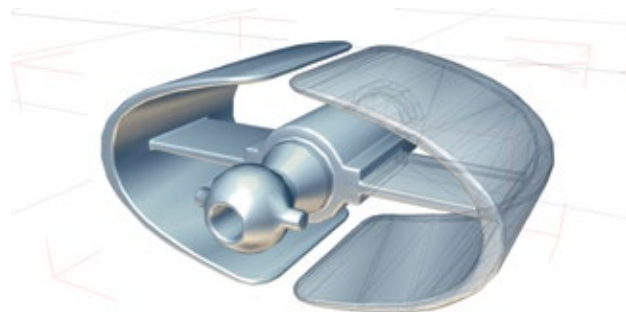

	<b>Cable-Snake® Cube</b>	4
	Outstanding features for ergonomically high quality designed furniture	
<b>NEW</b>	<b>Cable-Snake® Cube MX</b>	6
	Maximum volume with compact dimensions	
	<b>Cable-Snake® Pro</b>	8
	The tread-proof "Cable-Snake®"	
	<b>Cable-Snake® Classic</b>	10
	The classical "Allround-System"	
	<b>Cable-Snake® Flex</b>	12
	The flexible „Cable-Snake®“ with smallest bend radius	
<b>NEW</b>	<b>Cable-Snake® Flex II</b>	14
	Compact - flexible - compatible	
	<b>Cable-Snake® Quadro</b>	16
	The quadratic Snake for heavy duty	
	<b>Cable-Snake® Premium</b>	18
	Energy guidance for demanding office environments	
<b>NEW</b>	<b>Cable-Snake® Premium Tex</b>	20
	Exclusive cable sheath	
<b>NEW</b>	<b>Easy-Bridge</b>	21
	Cable guidance profile - Aluminium	
<b>NEW</b>	<b>E-Cube-K</b>	22
	Energy-tower for back-office workplaces	
<b>NEW</b>	<b>E-Cube M</b>	23
	Mobile energy-tower for highest demands	
	<b>Easy-Outlet</b>	24
	System-connection to floors	
	<b>Easy-Cover</b>	25
	System-connection to ceilings	
	<b>Easy-Clip, Easy-Floor, Easy-Switch</b>	26
	Floor-outlet-adapter, Floor plates, Junction box	
<b>NEW</b>	<b>Easy-Desk-3G, Easy-Rope, Easy-Steel, Easy-Ring, Easy-Glue</b>	27
	Mounting-clips, Tension-rope, Mounting-bar, Glass mounting	
	<b>Easy-Desk-2B, Easy-Stop, Easy-Fix</b>	28
	Desk brackets, Cable-tension-relief, Mounting chain links	
<b>NEW</b>	<b>Easy-Desk-1B, Easy-Desk-1K, Easy-Connect, Easy-Fix-90, Easy-Channel</b>	29
	Desk brackets, Universal joints, Mounting brackets of steel	
	<b>Easy-Duct, Easy-Tape</b>	30
	Cable duct, Velcro mounting	
	<b>Technical Information</b>	31
	Quality guarantee, environmental protection, certification, property rights	

# Cable-Snake® Cube

Outstanding features for ergonomically,  
high quality designed furniture

**Cable-Snake®**  
Professional Cablemanagement



**The Cable-Snake® Cube cable guiding system wins through its clean design and high level of functionality.**

The integrated flexible 2D/3D system is designed to unroll automatically and adapt to height adjustable desks.

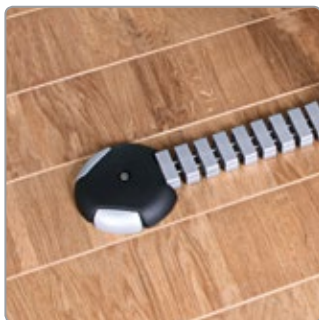

Cable-Snake® Cube, Easy-Outlet-Switch

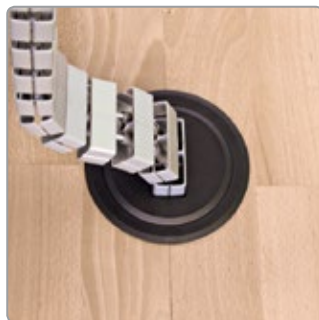

Cable-Snake® Cube, Easy-Outlet-I



2D/3D function for ergonomically designed furniture

When pulled apart, the Cable-Snake® Cube system rolls like a caterpillar track. When subjected to side forces, Cable-Snake® Cube stays in the set position. Pushed together the cable chain becomes a closed cable channel.

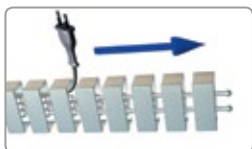

**Easy-Zip**  
Tool-free installation, like a zipper

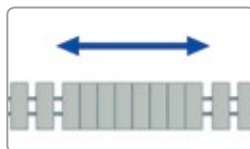

**Flexible in length**  
Also useable as closed cable channel

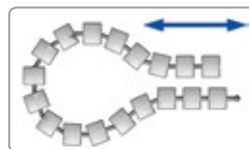

**2D/3D capability**  
Rolling characteristic optimised for ergonomic furniture



**Turning-force-stability**  
Stability due to patented connection



**Tread-proof**  
Tread-proof stretched up to 80 kg  
Tread-proof telescoped up to 100 kg

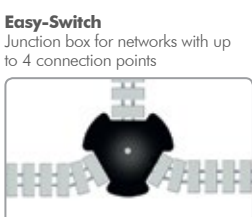

**Easy-Switch**  
Junction box for networks with up to 4 connection points



**Easy-Cover**  
Compatible to Easy-Cover ceiling outlets



**Easy-Outlet**  
Compatible to Easy-Outlet floor outlets



**Floor Outlet**  
Compatible to all common floor outlets

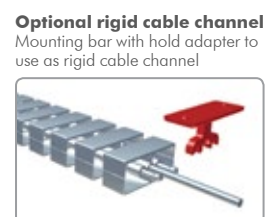

**Optional rigid cable channel**  
Mounting bar with hold adapter to use as rigid cable channel

# Cable-Snake® Cube

**Outstanding features for ergonomically,  
high quality designed furniture**

Cable-Snake® Cube is equipped with all the innovative functions developed by Q-LAB® since 1994. The integrated 2D/3D system has been optimized for ergonomic furniture so that it unrolls automatically with heightadjustable desks like a caterpillar track.

If certain higher forces are exceeded, the system is fully 3D-mobile and lengthflexible. The integrated memory function keeps the chain in the desired position. Cable-Snake® Cube is tread-proof to a limited extent and can also be used as a closed channel. The system is compatible with Cable-Snake® Cube MX, Pro, Classic, Flex, and Flex II and can also be easily connected with these systems. The high-quality design level with textured surfaces meet the most demanding requirements.

**Cable-Snake®**  
Professional Cablemanagement

Cable-Snake® Cube is equipped with the Easy Zip system developed by Q-LAB®, whereby cables can be threaded through like a zipper. The stainless steel mounting rod, Easy Steel makes rigid mounting possible such as with desk channels or between adjoining tables. The Easy Rope tension cord can resist traction forces up to 100 kg. (ceiling suspension). Cable-Snake® Cube is about 35% compressible and can optional be laid as a closed channel with or without the Easy Steel mounting rod. It can be made anti-slip on carpets by means of Easy Tape.

## Technical Data

Capacity up to about	25 cables
Stretched lengthwise, 34 chain links, approx.	100 cm
Length pushed together, approx.	69 cm
Material	Polypropylen



black RAL 9005



silver RAL 9006



light-grey RAL 7035



white RAL 9003



translucent nature



**Made in Germany**

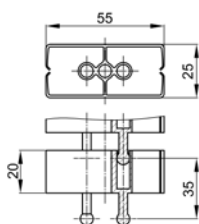

Cable-Snake® Cube



Set with floor-plate



Set with floor-outlet-adaptor

**Cable-Snake® Cube** approx. 100 cm (34 chain links)

**Set with floor-plate**, desk fixture, 2 screws 4x12mm

approx. 75 cm (25 chain links) for regular desk

approx. 125 cm (42 chain links) for sit-and standing desk

**Set with floor-outlet-adaptor**, desk fixture, 2 screws 4x12mm

approx. 75 cm (25 chain links) for regular desk

approx. 125 cm (42 chain links) for sit-and standing desk

KS-CUB-100

KS-CUB-S1-75

KS-CUB-S1-125

KS-CUB-S2-75

KS-CUB-S2-125

compatible with Cable-Snake

☒ Cube ☒ Cube MX ☒ Pro ☒ Classic ☒ Flex ☒ Flex II ☐ Quadro ☐ Premium

Colors  
☒ black ☒ silver ☒ light-grey ☒ white ☒ translucent

New!

# Cable-Snake® Cube MX

Maximum Volume with compact dimensions

**Cable-Snake®**  
Professional Cablemanagement



**The new cable guiding system Cable-Snake® Cube MX has the most cable capacity of all Cable-Snake® systems of Q-LAB®**

Cable-Snake® Cube MX is able to guide **up to 40** cables. The integrated 2D/3D system has been optimized for ergonomic furniture so that it unrolls perfectly with sit-and-standing desks.



Cable-Snake® Cube MX, Easy-Outlet-Switch

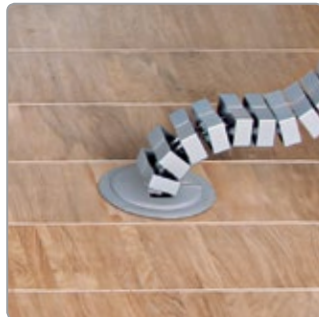

Cable-Snake® Cube MX, Easy-Outlet



Cable-Snake® Cube MX, floor-outlet

The system is compatible with Cable-Snake® Cube, Pro Classic, Flex, and Flex II and can be easily connected with these systems.

A wide range of accessories makes the system 100% network compatible and at any time expandable.

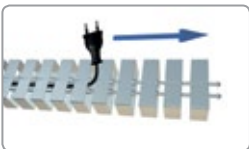

**Easy-Zip**  
Tool-free installation, like a zipper

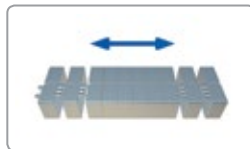

**Flexible in length**  
Also useable as closed cable channel for higher tread resistance

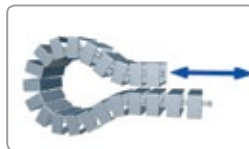

**2D/3D capability**  
Rolling characteristic optimised for ergonomic furniture



**Turning-force-stability**  
Turning force stability due to patented connection



**Optional rigid cable channel**  
Mounting bar with hold adapter to use as rigid cable channel

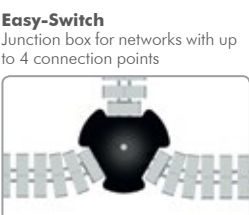

**Easy-Switch**  
Junction box for networks with up to 4 connection points



**Easy-Cover**  
Compatible to Easy-Cover ceiling-outlets



**Easy-Outlet**  
Compatible to Easy-Outlet floor-outlets



**Floor Outlet**  
Compatible to all common floor-outlets



**E-CUBE**  
Cable-Snake® Systems are compatible zu E-Cube-Energy profiles

# Cable-Snake® Cube MX

## Maximum Volume with compact dimensions

**Cable-Snake®**  
Professional Cablemanagement

Cable-Snake® Cube MX is equipped with all the innovative functions developed by Q-LAB® since 1994. The integrated 2D/3D system has been optimized for ergonomic furniture so that it unrolls automatically with heightadjustable desks like a caterpillar track.

If certain higher forces are exceeded, the system is fully 3D-mobile and lengthflexible. In addition, the integrated memory function keeps the chain in the desired position. Cable-Snake® Cube MX is tread-proof to a limited extent and can also be used as a closed channel. The system is compatible with Cable-Snake Cube, Pro, Classic, Flex and Flex II and can also be easily connected with these systems. The high-quality design with textured surfaces meet the most demanding requirements.

Cable-Snake® Cube MX is equipped with the Easy-Zip system developed by Q-LAB®, whereby cables can be threaded through like a zipper. The stainless steel mounting rod Easy-Steel makes rigid mounting possible such as with desk channels or between adjoining tables. The Easy Rope tension rope can resist traction forces up to 100 kg (ceiling suspension). Cable-Snake® Cube MX is about 35% compressible and can optional be laid as a closed channel on the floor, with or without the Easy-Steel mounting rod. It can be made anti-slip on carpets by means of velcro-system Easy-Tape.

### Technical Data

Capacity up to about	40 cables
Stretched lengthwise, 34 chain links, approx.	100 cm
Length pushed together, approx.	69 cm
Material	Polypropylen



black RAL 9005



silver RAL 9006



light-grey RAL 7035



white RAL 9003



translucent nature



**Made in Germany**

**New**

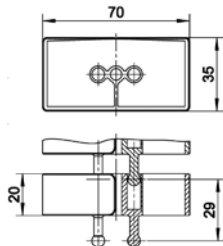

Cable-Snake® Cube MX

**Cable-Snake® Cube MX** approx. 100 cm (34 chain links)

**Set with floor-plate**, desk fixture, 2 screws 4x12mm

approx. 75 cm (25 chain links) for regular desk

approx. 125 cm (42 chain links) for sit-and standing desk

**Set with floor-outlet-adapter**, desk fixture, 2 screws 4x12mm

approx. 75 cm (25 chain links) for regular desk

approx. 125 cm (42 chain links) for sit-and standing desk



Set with floor-plate

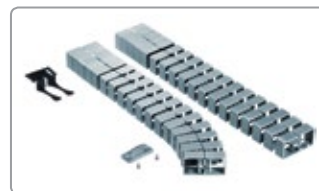

Set with floor-outlet-adapter

KS-CMX-100

KS-CMX-S1-75

KS-CMX-S1-125

KS-CMX-S2-75

KS-CMX-S2-125

compatible with Cable-Snake

☒ Cube ☒ Cube MX ☒ Pro ☒ Classic ☒ Flex ☒ Flex II ☐ Quadro ☐ Premium

Colors  
☒ black ☒ silver ☒ light-grey ☒ white ☒ translucent

# Cable-Snake® Pro

## The tread-proof "Cable-Snake®"

**Cable-Snake®**  
Professional Cablemanagement



The cable guiding system **Cable-Snake® Pro** is particularly **tread-proof** and thus particularly suitable for laying in corridor areas with heavy foot traffic.

The tread proof is **80 kg** when stretched and approx. **120 kg** compressed.

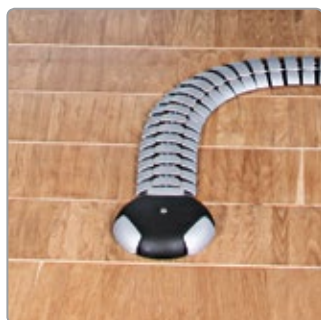

Cable-Snake® Pro, Easy-Outlet-Switch

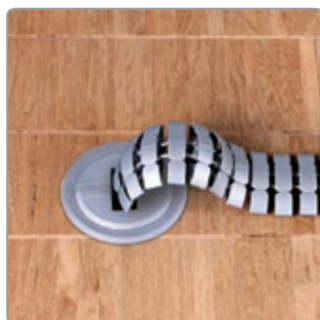

Cable-Snake® Pro, Easy-Outlet-I



Cable-Snake® Pro, E-Cube M

The system is compatible with cable bridge Easy Bridge and with Cable-Snake® Cube, Cube MX, Classic, Flex and Flex II and can be easily connected with these systems. A wide range of accessories makes the system 100% network compatible and expandable at any time.

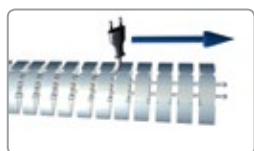

**Easy-Zip**  
Tool-free installation, like a zipper

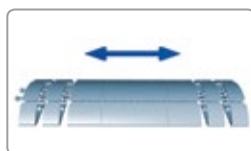

**Flexible in length**  
Also useable as closed cable channel for higher tread resistance

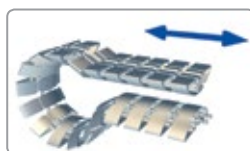

**2D/3D capability**  
Rolling characteristic optimised for ergonomic furniture

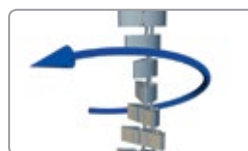

**Turning-force-stability**  
Turning force stability due to patented connection



**Tread-proof**  
Tread-proof stretched up to 80 kg  
Tread-proof telescoped up to 120 kg

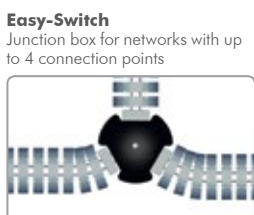

**Easy-Switch**  
Junction box for networks with up to 4 connection points



**Easy-Cover**  
Compatible to Easy-Cover ceiling-outlets



**Easy-Outlet**  
Compatible to Easy-Outlet floor-outlets



**Floor-Outlet**  
Compatible to all common floor-outlets



**Easy-Bridge**  
Compatible with Easy-Bridge cable bridge

# Cable-Snake® Pro

## The tread-proof "Cable-Snake®"

**Cable-Snake®**  
Professional Cablemanagement

The integrated 2D/3D system has been optimized for ergonomic furniture so that it unrolls automatically with height-adjustable desks like a caterpillar track. If certain higher forces are exceeded, the system is fully 3D-mobile and lengthflexible. In addition, the integrated memory function keeps the chain in the desired position.

Cable-Snake® Pro is telescoped and also useable as a closed channel. The high-quality design with textured surfaces meet the most demanding requirements.

Easy-Zip system developed by Q-LAB® cables can be easily threaded through like a zipper.

With the Easy Rope tension cord can resist traction forces up to 100 kg.

The stainless steel mounting rod Easy Steel makes rigid mounting possible such as desk channels or on the floor. The system is compatible with Aluminium-Cable-Bridge Easy Bridge and can be easily connected with these systems. This creates a fully networkable flooringsystem, in which different curves and straight lines are possible. Easy Tape velcros fix this system on carpets

### Technical Data

Capacity up to about	30 cables
Stretched lengthwise, 34 chain links, approx.	100 cm
Length pushed together, approx.	70 cm
Compressibility, approx.	35%
Material	Polypropylen



black RAL 9005



silver RAL 9006



light-grey RAL 7035



white RAL 9003



translucent nature



secure



**Made in Germany**

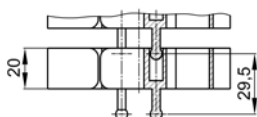
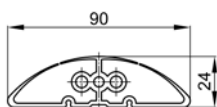

Cable-Snake® Pro

**Cable-Snake® Pro** approx. 100 cm (34 chain links)

**Set with floor-plate**, desk fixture, 2 screws 4x12mm

approx. 75 cm (24 chain links) for regular desk

approx. 125 cm (42 chain links) for sit-and standing desk

**Set with floor-outlet-adapter**, desk fixture, 2 screws 4x12mm

approx. 75 cm (24 chain links) for regular desk

approx. 125 cm (42 chain links) for sit-and standing desk



Set with floor-plate



Set with floor-outlet-adapter

KS-PRO-100

KS-PRO-S1-75

KS-PRO-S1-125

KS-PRO-S2-75

KS-PRO-S2-125

compatible with Cable-Snake

☒ Cube ☒ Cube MX ☒ Pro ☒ Classic ☒ Flex ☒ Flex II ☐ Quadro ☐ Premium

☒ secure ☒ black ☒ silver ☒ light-grey ☒ white ☒ translucent

Colors

# Cable-Snake® Classic

## The classical "Allround-System"

**Cable-Snake®**  
Professional Cablemanagement



**The Cable-Snake® Classic cable guiding system is the classical "Allround-System".**

A wide range of applications and adapters make the system compatible with all connection points.



Cable-Snake® Classic , Easy-Outlet-Switch

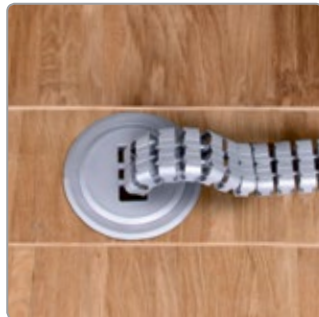

Cable-Snake® Classic , Easy-Outlet-I

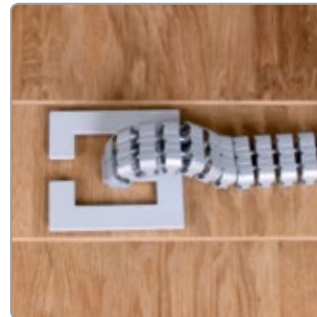

Cable-Snake® Classic, Easy-Floor-2K

The compact construction with proven 3 chamber system makes for orderly guidance of cables.

An extensive range of accessories and compatibility with our other systems make Cable-Snake® Classic the "Allround-System".

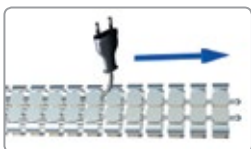

**Easy-Zip**  
Tool-free installation, like a zipper

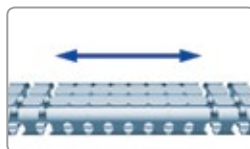

**Flexible in length**  
Also useable as closed cable channel for higher tread resistance



**Wide range of accessories**  
Compatible with all Cable-Snake® cable management systems



**Turning-force-stability**  
Stability due to patented connection



**Tread-proof**  
Tread-proof stretched up to 75 kg  
Tread-proof telescoped up to 90 kg

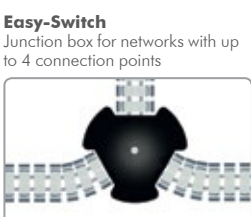

**Easy-Switch**  
Junction box for networks with up to 4 connection points



**Easy-Cover**  
Compatible to Easy-Cover ceiling-outlets



**Easy-Outlet**  
Compatible to Easy-Outlet floor-outlets



**Floor-Outlet**  
Compatible to all common floor-outlets



**Easy-Bridge**  
Compatible with Easy-Bridge cable bridge

# Cable-Snake® Classic

## The classical "Allround-System"

**Cable-Snake®**  
Professional Cablemanagement

The Cable-Snake® Classic cable guiding system is particularly compact and universally applicable. The system is limited tread-proof. The extensive accessory range makes the system a classical "Allround-System" for every case of application. The Cable-Snake® Classic can carry up to 20 cables, is flexible lengthwise and with 3 chambers allows separation of data and power cables. The innovative geometry makes "squeeze safe" side branching of individual cables possible at any point. The compact design and the Easy Zip system meet exacting demands. The system is compatible with Easy-Bridge, Cable-Snake® Cube, Cube MX, Pro, Pro Flex and Flex II and can be easily connected with these systems.

The system is suitable for all applications with horizontal and vertical cable runs. Short-term loads of up to 75 kg on 5 chain links at an ambient temperature of 20° are possible in limited foot traffic areas.

### Technical Data

Capacity up to about	20 cables
Stretched lengthwise, 46 chain links approx.	100 cm
Length pushed together approx.	72 cm
Material	Polypropylen



black RAL 9005



silver RAL 9006



light-grey RAL 7035



white RAL 9003



translucent nature



**Made in Germany**

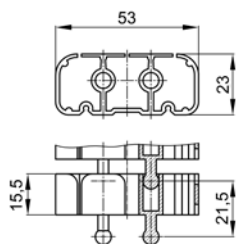

Cable-Snake® Classic

**Cable-Snake® Classic** approx. 100 cm (46 chain links)

**Set with floor-plate**, desk fixture, 2 screws 4x12mm

approx. 75 cm (33 chain links) for regular desk

approx. 125 cm (56 chain links) for sit-and standing desk

**Set with floor-outlet-adapter**, desk fixture, 2 screws 4x12mm

approx. 75 cm (33 chain links) for regular desk

approx. 125 cm (56 chain links) for sit-and standing desk



Set with floor-plate

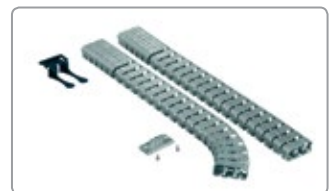

Set with floor-outlet-adapter

KS-CLA-100

KS-CLA-S1-75

KS-CLA-S1-125

KS-CLA-S2-75

KS-CLA-S2-125

compatible with Cable-Snake

☒ Cube ☒ Cube MX ☒ Pro ☒ Classic ☒ Flex ☒ Flex II ☐ Quadro ☐ Premium

Colors  
☒ black ☒ silver ☒ light-grey ☒ white ☒ translucent

# Cable-Snake® Flex

The flexible "Cable-Snake®" with smallest bend radius

**Cable-Snake®**  
Professional Cablemanagement



**The Cable-Snake® Flex cable guiding system wins through greatest flexibility with functional design.**

The three separate chambers lead the cables, well laid out and protected, to all relevant connection points.



Cable-Snake® Flex, Easy-Outlet-II

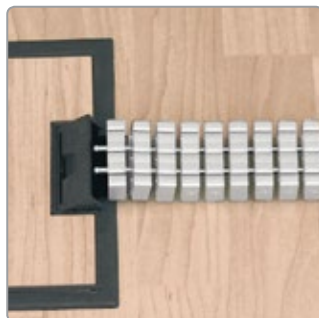

Cable-Snake® Flex, Floor-Outlet

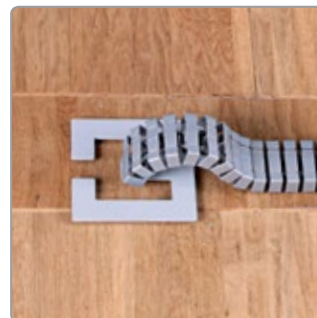

Cable-Snake® Flex, Easy-Floor-2K

**Cable-Snake® Flex** is the cable guiding system with the **smallest bend radius** and the highest number of chain links per running meter. The distance between chain links is very small whereby increased tread resistance and safety are achieved.



**Zip-Stop**  
Secured cable chambers with "Parental Control"

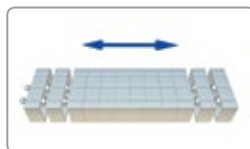

**Flexible in length**  
Also useable as closed cable channel for higher tread resistance



**Wide range of accessories**  
Compatible with all Cable-Snake® cable guiding systems



**Turning-force-stability**  
Turning force stability due to patented connection



**Tread-proof**  
Tread-proof stretched up to 80 kg  
Tread-proof telescoped up to 100 kg

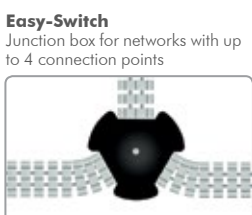

**Easy-Switch**  
Junction box for networks with up to 4 connection points



**Easy-Cover**  
Compatible to Easy-Cover ceiling outlets



**Easy-Outlet**  
Compatible to Easy-Outlet floor outlets



**Floor-Outlet**  
Compatible to all common floor-outlets

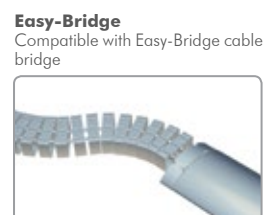

**Easy-Bridge**  
Compatible with Easy-Bridge cable bridge

# Cable-Snake® Flex

The flexible "Cable-Snake®" with smallest bend radius

**Cable-Snake®**  
Professional Cablemanagement

The Cable-Snake® Flex system is free to move in 3 directions and has approx. 25% flexibility lengthwise. The functional design wins through its clear lines and precise angular form with integrated three chamber system for separated guiding of data- and power lines. The Cable-Snake® Flex system is compatible with all regular floor sockets. Extensive accessories make the system compatible and network-capable for different applications.

Cable-Snake® Flex system is compatible with Cable Snake Cube, Cube MX, Pro, Classic and Flex II and can be easily connected with these systems. Using the junction boxes Easy-Switch and Easy-Switch Premium - complex networks can be created.

Cable-Snake® Flex is suitable for horizontal and vertical cable runs and is sufficiently tread-proof for low foot traffic areas. Short-term loads up to 80 kg on 5 chain links.

## Technical Data

Capacity up to about	20 cables
Stretched lengthwise, 58 chain links approx.	100 cm
Length pushed together approx.	74 cm
Material	Polypropylen



black RAL 9005



silver RAL 9006



light-grey RAL 7035



white RAL 9003



translucent nature



**Made in Germany**

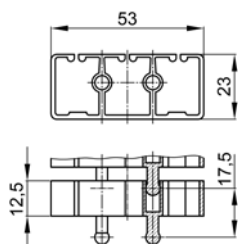

Cabel-Snake® Flex

**Cable-Snake® Flex** approx. 100 cm (58 chain links)

**Set with floor-plate**, desk fixture, 2 screws 4x12mm

approx. 75 cm (41 chain links) for regular desk

approx. 125 cm (69 chain links) for sit-and standing desk

**Set with floor-outlet-adapter**, desk fixture, 2 screws 4x12mm

approx. 75 cm (41 chain links) for regular desk

approx. 125 cm (69 chain links) for sit-and standing desk



Set with floor-plate



Set with floor-outlet-adapter

KS-FLE-100

KS-FLE-S1-75

KS-FLE-S1-125

KS-FLE-S2-75

KS-FLE-S2-125

compatible with Cable-Snake

☒ Cube ☒ Cube MX ☒ Pro ☒ Classic ☒ Flex ☒ Flex II ☐ Quadro ☐ Premium

Colors  
☒ black ☒ silver ☒ light-grey ☒ white ☒ translucent

New

# Cable-Snake® Flex II

Compact - flexible - compatible

**Cable-Snake®**  
Professional Cablemanagement



**Cable-Snake® Flex-II is compatible with all parts of the Q-LAB® system .**

The original design of 1994 was developed step by step and carefully innovated . Function and capacity were drastically improved. Easy mounting, compact size and the high number of chain links provide maximum **flexibility and function.**



Cable-Snake® Flex II, Easy-Outlet-Switch

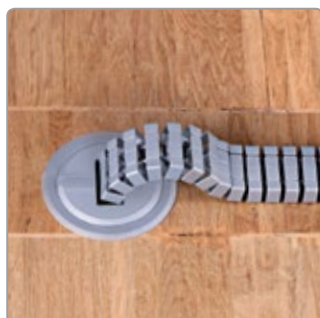

Cable-Snake® Flex-II, Easy-Outlet I

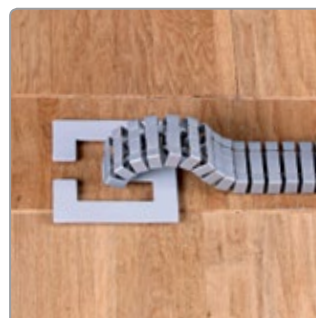

Cable-Snake® Flex II, Easy-Floor-2K

Smallest bend radius gives you a perfect rolling effect at height adjustable desks. The individual chain links can be also completely pushed together as a self-locking cable channel and so are closed.

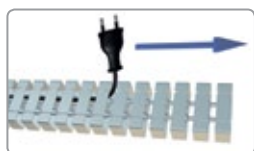

**Easy-Zip**  
Tool-free installation, like a zipper

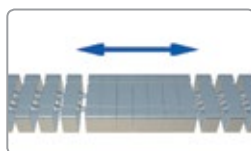

**Flexible in length**  
Also useable as closed cable channel for higher tread resistance

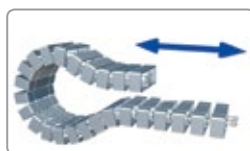

**2D/3D capability**  
Rolling characteristic optimised for ergonomic furniture

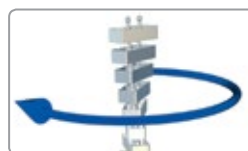

**Turning-force-stability**  
Stability due to patented connection



**Tread-proof**  
Tread-proof stretched up to 70 kg  
Tread-proof telescoped up to 90 kg

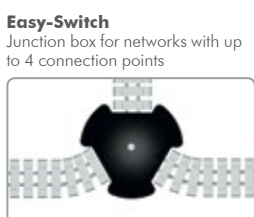

**Easy-Switch**  
Junction box for networks with up to 4 connection points



**Easy-Cover**  
Compatible to Easy-Cover ceiling-outlets



**Easy-Outlet**  
Compatible to Easy-Outlet floor-outlets



**Floor-Outlet**  
Compatible to all common floor-outlets

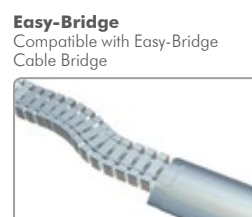

**Easy-Bridge**  
Compatible with Easy-Bridge Cable Bridge

# Cable-Snake® Flex II

## Compact - flexible - compatible

**Cable-Snake®**  
Professional Cablemanagement

The Cable-Snake® Flex system is free to move in 3 directions and has approx. 25% flexibility lengthwise. The functional design wins through its clear lines and precise angular form with integrated two chamber system for separated guiding of data- and power lines.

Cable-Snake® Flex II is equipped with all the innovative functions developed by Q-LAB® since 1994. The integrated 2D/3D system has been optimized for ergonomic furniture so that it unrolls automatically with height-adjustable desks like a caterpillar track. With the application of higher forces, the system is fully 3D mobile. The integrated memory function keeps the chain in the desired position. Cable-Snake® Flex II is tread-proof to a limited extent and can also be used as a closed channel.

The system is compatible with Cable-Snake® Cube, Cube MX, Pro, Classic and Flex and can be easily connected with these systems. The high-quality design with textured surfaces meets the most demanding requirements.

The Cable-Snake® Flex II system is compatible with all regular floor-outlets. A wide range of accessories make the system compatible and network-capable for different applications. Cable-Snake® Flex II is suitable for horizontal and vertical cable guidance and is sufficiently tread-proof for low foot traffic areas. Short-term loads of up to 70 kg on 5 chain links at an ambient temperature of 20° are possible.

### Technical Data

Capacity up to about	20 cables
Stretched lengthwise, 54 chain links, approx.	100 cm
Length pushed together approx.	74 cm
Material	Polypropylen



black RAL 9005



silver RAL 9006



light-grey RAL 7035



white RAL 9003



translucent nature



**Made in Germany**

**New**

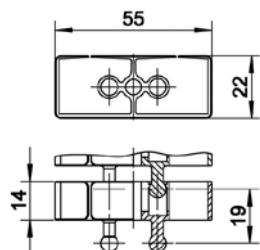

Cable-Snake® Flex II

**Cable-Snake® Flex II** approx. 100 cm (54 chain links)

**Set with floor-plate**, desk fixture, 2 screws 4x12mm

approx. 75 cm (38 chain links) for regular desk

approx. 125 cm (65 chain links) for sit-and standing desk

**Set with floor-outlet-adapter**, desk fixture, 2 screws 4x12mm

approx. 75 cm (38 chain links) for regular desk

approx. 125 cm (65 chain links) for sit-and standing desk

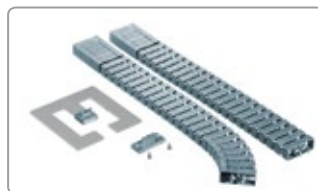

Set with floor-plate

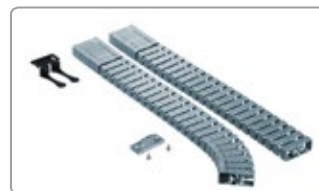

Set with floor-outlet-adapter

KS-FLE II-100

KS-FLE II-S1-75

KS-FLE II-S1-125

KS-FLE II-S2-75

KS-FLE II-S2-125

compatible with Cable-Snake

☒ Cube ☒ Cube MX ☒ Pro ☒ Classic ☒ Flex ☒ Flex II ☐ Quadro ☐ Premium

Colors  
☒ black ☒ silver ☒ light-grey ☒ white ☒ translucent

# Cable-Snake® Quadro

## The quadratic Snake for heavy duty

**Cable-Snake®**  
Professional Cablemanagement



The cable guiding system **Cable-Snake® Quadro** is the cross section quadratic **Cable-Snake®**.

The timeless design impresses with clear lines and functional design language.

The **Zip-stop-system** impedes the unintended removal of cables and offers in public areas an intended increased protection of the cables.

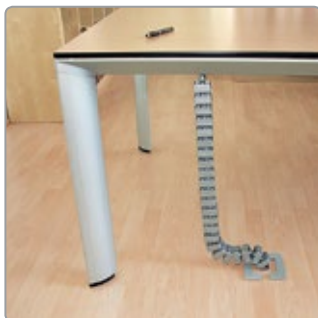

Cable-Snake® Quadro



Cable-Snake® Quadro, Easy Outlet-I

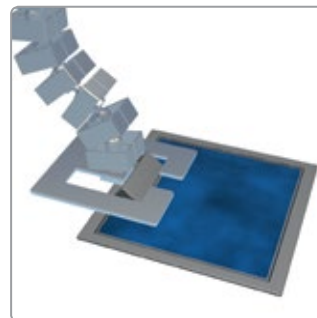

Cable-Snake® Quadro, Easy-Floor-Quadro

The cable guiding system **Cable-Snake® Quadro** is very traction stable and can therefore be used for the installation on ceilings. New Sets with massive floor plates have been optimized and are now also compatible to floor-outlets.



**Zip-Stop**  
Secured cable chambers with "Parental Control"

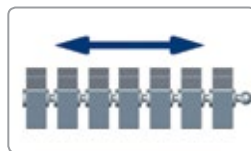

**Traction Stable**  
Transmission of traction up to 5 kg at ceiling suspension



**„Bio-plastic“**  
Bio-plastics on request. Color white-natural.



**„Bio-plastic“**  
Bio-plastics on request. Color „light-wood“.



**„Bio-plastic“**  
Bio-plastics on request. Color „dark-wood“

**Easy-Tape**  
Anti-slip and detachable attachment systems



**Easy-Cover**  
Compatible to Easy-Cover ceiling-outlets



**Easy-Outlet**  
Compatible to Easy-Outlet floor outlets



**Floor Outlets**  
Compatible to all common floor outlets

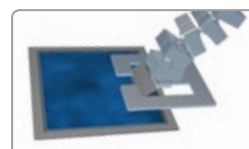

**Compatible**  
Compatible to Cable-Snake® Premium and Premium Tex



# Cable-Snake® Quadro

## The quadratic Snake for heavy duty

**Cable-Snake®**  
Professional Cablemanagement

Cable-Snake® Quadro is ideal for the electrification of single workstations for regular tables. The system is very traction stable and ideal for suspensions from the ceiling. The classical-functional design wins through its clear lines and precise quadratic form with integrated two chamber system for separation of data and power lines. Accessories make the system compatible for different applications and network capability. Cable-Snake® Quadro is compatible with Cable-Snake® Premium and Premium Tex.

The cable chambers integrated **Zip-stop system** prevents the unintended removal of installed cables especially in public areas.

### Technical Data

Capacity up to approx.	40 cables
Stretched lengthwise, 32 chain links, approx.	100 cm
Material	Polypropylen

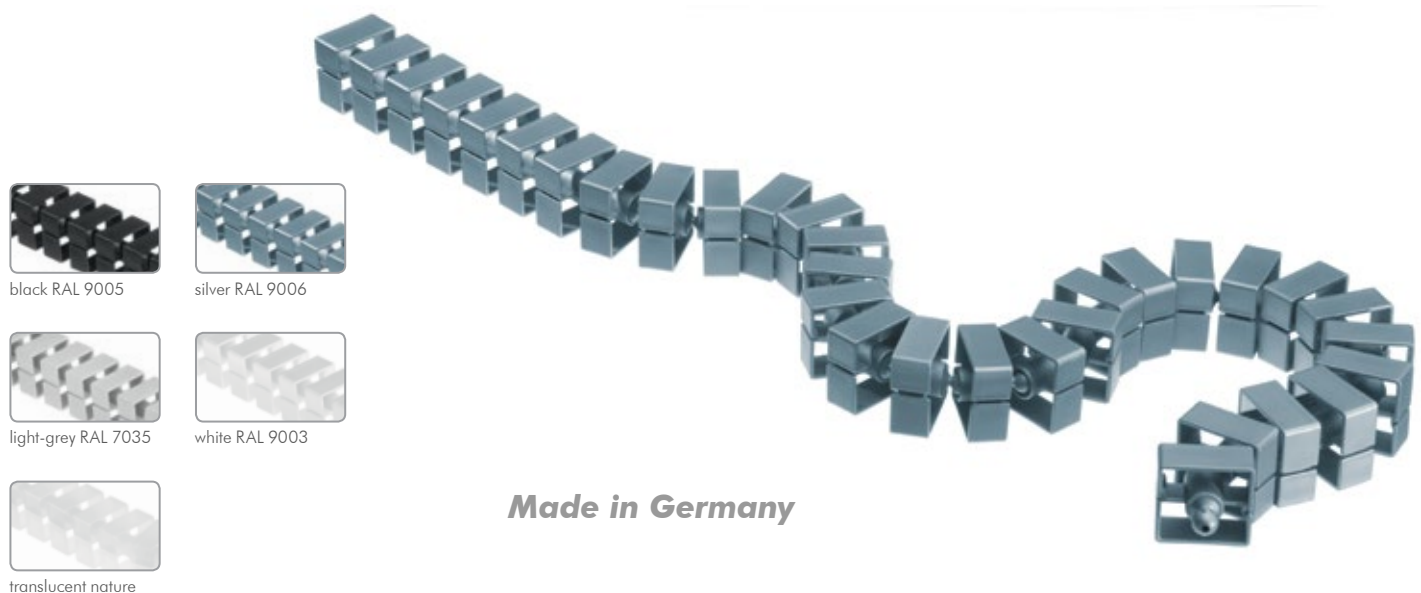

Cable-Snake® Quadro



Set with floor-plate



Set with floor-plate

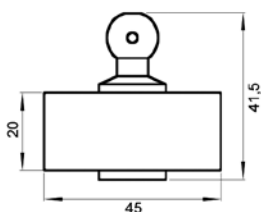

**Cable-Snake® Quadro** approx. 100 cm (32 chain links)

**Set with floor-plate**, desk fixture, 2 screws 4x12mm

approx. 75 cm (23 chain links) for regular desk

approx. 125 cm (39 chain links) for sit-and-standing desk

The Set with floor-plate is also suitable for connections to floor-outlets

KS-QUA-100

KS-QUA-S1-75

KS-QUA-S1-125

compatible with Cable-Snake

☐ Cube ☐ Cube MX ☐ Pro ☐ Classic ☐ Flex ☐ Flex II ☒ Quadro ☒ Premium

Colors  
☒ black ☒ silver ☒ light-grey ☒ white ☒ translucent

# Cable-Snake® Premium

Energy guidance for demanding office environments

**Cable-Snake®**  
Professional Cablemanagement



**The Cable-Snake® Premium was especially developed for high-class office furniture.**

The narrow aspect in combination with a high quality textured surface stresses the high level design requirements.



Ceiling suspension, Connection to E-Cube



Cable-Snake® Premium, Easy-Floor-Premium

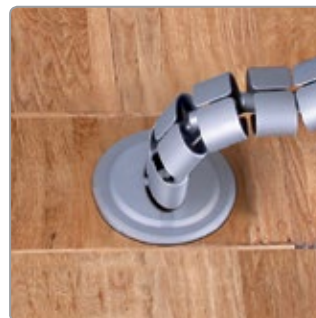

Cable-Snake® Premium, Easy-Outlet-Premium

All accessories, despite their fine design are of an extremely "massive" quality and will have a long life. All Q-LAB® developed innovations unite in this system. The chain links can be pushed together into a self locking elliptical cablechannel.



**Easy-Zip**  
Tool-free installation, like a zipper

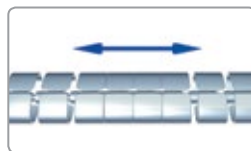

**Flexible in length**  
Also useable as closed cable channel for higher tread resistance

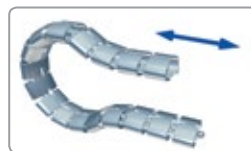

**2D/3D capability**  
Rolling characteristic optimised for ergonomic furniture

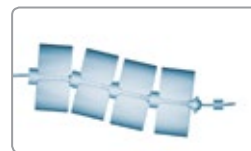

**Easy-Rope**  
Tension cord for resisting traction forces up to 100 kg



**Optional rigid cable channel**  
Mounting bar with hold adapter to use as rigid cable channel

**Easy-Switch Premium**  
Junction box for networks with up to 4 connection points



**Easy-Cover**  
Compatible to Easy-Cover ceiling-outlets



**Easy-Outlet**  
Compatible to Easy-Outlet floor-outlets



**Floor-Outlets**  
Compatible to all common floor-outlets

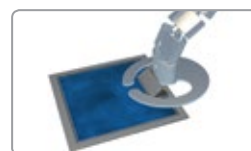

**Compatible**  
Compatible to Cable-Snake® Premium Tex and Quadro



# Cable-Snake® Premium

## Energy guidance for demanding office environments

**Cable-Snake®**  
Professional Cablemanagement

Cable management system Cable-Snake® Premium meets the highest design standards with maximum functionality. The elliptical shape offers clear lines and high-quality textured surfaces.

Cable-Snake® Premium is equipped with all the innovative functions developed by Q-LAB® since 1994.

The integrated 2D/3D system has been optimized for ergonomic furniture so that it unrolls automatically with height-adjustable desks like a caterpillar track. 2 chamber system for separation of data and power cables.

The system is compatible with Cable-Snake® Premium Tex and Quadro and can be easily connected with these systems. The Easy Rope tension cord can resist traction forces up to 100 kg. The stainless steel mounting rod, Easy Steel makes

rigid mounting possible such as with desk channels

The Cable-Snake® Premium system is compatible with all regular floor-outlets. A wide range of accessories makes the system network-capable.

### Technical Data

Capacity up to about	40 cables
Stretched lengthwise, 22 chain links, approx.	100 cm
Length pushed together approx.	78 cm
Material	Polypropylen



black RAL 9005



silver RAL 9006



light-grey RAL 7035



white RAL 9003



translucent nature

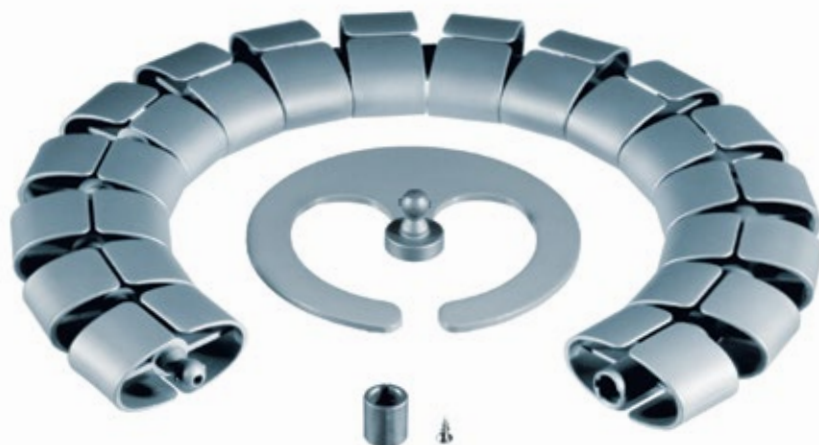

**Made in Germany**



Cable-Snake® Premium.

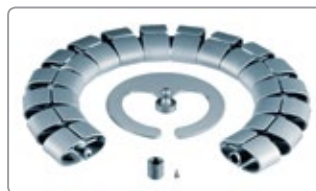

Set with floor-plate



Set with floor-plate

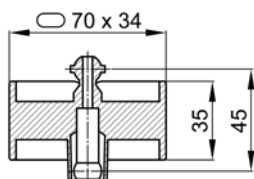

**Cable-Snake® Premium** approx. 100 cm (22 chain links)

**Set with floor-plate**, desk fixture, 2 screws 4x12mm

approx. 75 cm (16 chain links) for regular desk

approx. 125 cm (27 chain links) for sit-and standing desk

The Set with floor-plate is also suitable for connections to floor-outlets

KS-PRE-100

KS-PRE-S1-75

KS-PRE-S1-125

compatible with Cable-Snake

☐ Cube ☐ Cube MX ☐ Pro ☐ Classic ☐ Flex ☐ Flex II ☒ Quadro ☒ Premium

Colors  
☒ black ☒ silver ☒ light-grey ☒ white ☒ translucent

New

# Cable-Snake® Premium Tex

## Exclusive cable-sheath

**Cable-Snake®**  
Professional Cablemanagement



Cable-Snake® Premium Tex "cobra"



Cable-Snake® Premium Tex "rosso"



Cable-Snake® Premium Tex "black"

**Cable-Snake® Premium Tex is the high-quality solution for users who want to completely en-case cables.**

The system will be produced according to your requirements from your desired material. Adequate to the individual furniture line, we use high quality leather, alcantara and fabrics according to your requests.

Variants with velcro, zipper and buttons are producible. In the end-segments of each Premium Tex a removable chain link of Cable-Snake® Premium (via velcro system) is integrated.

Thereby cables can be installed at any time quickly and neatly. All accessories of Cable-Snake® Quadro and Premium can be combined with this system forming the first networkable "cable tube".



Premium Tex mounting-set "silver"



Premium Tex complete-set "alkantara black"



Premium Tex complete-set "velours black"

### Cable-Snake® Premium Tex mounting-set without sheath

2 chain links Cable-Snake® Premium with high strength 3M-velcro-sheath, desk fixture Easy-Desk-1B including fixing screw 4x12 mm, floor-plate Easy-Floor Premium 2x hook-tape to sew in

KS-PRE-TEX-S1

### Cable-Snake® Premium Tex mounting-set with sheath

Complete-set with high quality textile cable-sheath in "alkantara-" or "velours-look". Zipper YKK. Length without accessories approx. 70 cm. Length incl. desk-connection and floor plate approx. 75 cm.

KS-PRE-TEX-S2

compatible with Cable-Snake

☐ Cube ☐ Cube MX ☐ Pro ☐ Classic ☐ Flex ☐ Flex II ☒ Quadro ☒ Premium

☒ Fabrics, Colors and length on customer request

Colors

New

# Easy-Bridge

## Cable guidance profile - Aluminium

**Cable-Snake®**  
Professional Cablemanagement

**The aluminum cable bridge Easy-Bridge is suitable for extreme loads.**

Easy-Bridge cable bridges are tread-proof and ideal for installation in busy foot-traffic areas. The system is compatible with Cable-Snake® Cube, Pro, Classic, Flex and Flex II and can be easily connected with these systems.

Curves with different radii and lengths are made by Cable-Snake® cable-chains. By using individual links of the Cable-Snake® Pro, any distance extension can be bridged without sawing off any profiles.

Multiple Easy-Bridge cable bridges can be connected together without using any tools. Easy Bridge is fixed on carpets with preassembled velcro system or with 3M double-adhesive tape - anti slip - on smooth floors.



Easy-Bridge with Cable-Snake® Pro

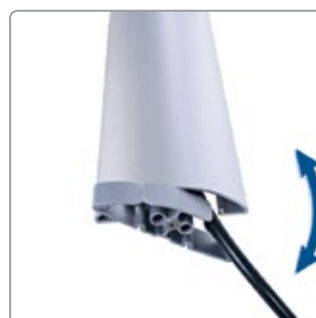

Easy-Bridge, swingable Cable Protection



Easy-Bridge System-Modules



Hook tape Double-adhesive tape



Easy-Bridge simple connected



Easy-Bridge. optional with closure strips

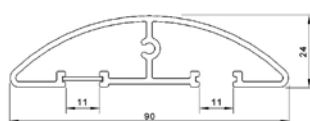

**Easy-Bridge** Cable-bridge. Anodized Aluminium. Delivery including mounted swingable connection joint. Color of the connection joint according customer requirements. Closure strips optional.

**Easy-Bridge-H-50** with 50 cm mounted hook-tape

**Easy-Bridge-D-50** with 50 cm mounted double-adhesive-tape

**Easy-Bridge-H-100** with 100 cm mounted hook-tape

**Easy-Bridge-D-100** with 100 cm mounted double-adhesive-tape

**Easy-Bridge-closure strips** for 2 slots a 50cm=2x50 cm

**Easy-Bridge-closure strips** for 2 slots a 100 cm=2x100 cm

E-BRI-H-50

E-BRI-D-50

E-BRI-H-100

E-BRI-D-100

E-BRI-V-50

E-BRI-V-100

compatible with Cable-Snake

☒ Cube ☒ Cube MX ☒ Pro ☒ Classic ☒ Flex ☒ Flex II ☐ Quadro ☐ Premium

Colors

☒ Aluminium anodized, Coupling element colored

New

# E-Cube-K

Energy-tower for back-office workplaces

**Cable-Snake®**  
Professional Cablemanagement



**The energy tower E-Cube-K enables a flexible decentralised power- and data technology supply for workplaces.**

Up to 2x4 sockets, chargers, network technology and excess cables are neatly stored in the E-Cube-K.

E-Cube-K is the economically priced energy-tower for back offices and is slip resistant on carpets.

E-Cube-K can be connected to all standard floor-outlets, cable-channels and ceiling-outlets.



E-Cube-K-540-Point



E-Cube-K-540-II



E-Cube-K-720-Move

E-Cube-K is compatible to all Cable-Snake®-systems and to cable bridge Easy-Bridge.

Select your E-Cube-K with up to 2x4 sockets inside and the variable sockets in the lid.



203 x 203 mm



240 x 240 mm



Slip resistant plates on carpets



1x 4-fold Socket 2x 4-fold socket



Telescope outlet Move Point

**E-Cube-K-540 Casing box**

**E-Cube-K-720 Casing box**

Netbox M4 diagonal 4x 230V

Netbox-Point 2x 230 V and 2x RJ45 KAT6 Genderchanger

Netbox-Move 3x 230 V

Cable 1m, 3m or 6 m

Easy-Cover or telescope outlet in the lid. Socket outlet on request.

E-CUBE-K-540

E-CUBE-K-720

Netbox-M4

Netbox-Point

Netbox-Move

Connection cable

compatible with Cable-Snake

☒ Cube ☒ Cube MX ☒ Pro ☒ Classic ☒ Flex ☒ Flex II ☒ Quadro ☒ Premium

Colors

☒ Aluminium anodized lid and floor plastic black

New

# E-Cube-M

Mobile energy-tower for highest demands

**Cable-Snake®**  
Professional Cablemanagement

**E-Cube-M is the high-quality mobile data- and power supply for congress, lecture, conference and executive offices.**

If you would like to remove the speaker's desk and the matching IT technology fast, for example, after a lecture, simply move E-Cube-M with its attached Cable-Snake® into the next room and you can start the buffet immediately.



The cubic clear design of E-Cube-M convinces through the massive all-metal design made of 100% aluminum with high quality anodized surfaces.

Fixed, fold-out or extendible sockets in the lid solve every task immediately.



E-Cube-M-540-Axial

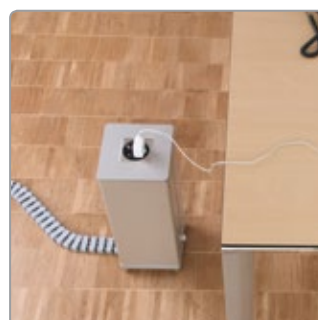

E-Cube-M-540-Point



E-Cube-M-540-Point



Alu base Metal-spheric rolls



1x 4-fold socket 2x 4-fold socket



Axial Move Point



**E-Cube-M-540 Casing box**

**E-Cube-M-720 Casing box**

Netbox M4 diagonal 4x 230V

Netbox-Point 2x 230 V and 2x RJ45 KAT6 Genderchanger

Netbox-Move 3x 230 V

Netbox-Axial 1x 230V and 2x RJ45 KAT6 Genderchanger

Cable 1m, 3m or 6 m

Easy-Cover or telescope outlet in the lid. Socket outlet on request

E-CUBE-M-540

E-CUBE-M-720

Netbox-M4

Netbox-Point

Netbox-Move

Netbox-Axial

Connection cable

compatible with Cable-Snake

☒ Cube ☒ Cube MX ☒ Pro ☒ Classic ☒ Flex ☒ Flex II ☒ Quadro ☒ Premium

☒ Aluminium anodized lid and floor massive Aluminium.

Colors

# Easy-Outlet

## System-connection to floors

**Cable-Snake®**  
Professional Cablemanagement



Easy-Outlet-TA closed



Easy-Outlet-TA extended



Easy-Outlet-Switch with up to 3 connections



Easy-Outlet-I connection 1x Cable-Snake®

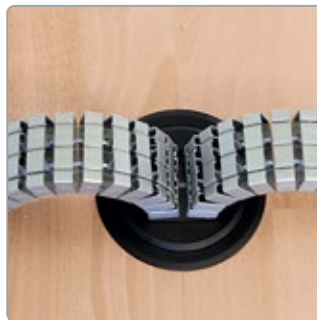

Easy-Outlet-II connection 2x Cable-Snake®



Easy-Outlet-Premium, Cable-Snake® Premium



Easy-Outlet-M-B stainless steel radial rotary-structure



Easy-Outlet-M-B stainless steel glass-bead-blasted

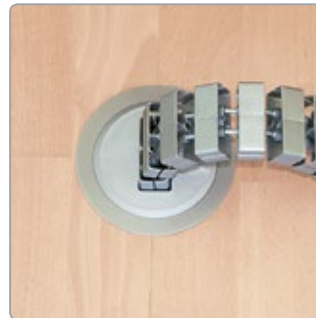

Easy-Outlet-M-I stainless steel & Polypropylen

**The Easy-Outlet series solves any task regarding flooroutlets.**

Q LAB® floor outlets can be installed afterwards at any time by drilling a hole in the raised floor.

Place the floor-outlet exactly where you need it.

Choose between the telescope outlet Easy-Outlet-TA, the triple outlet Easy-Outlet-Switch as well the Easy-Outlet-I, -II, -Premium and Quadro to the vertical connection of the Cable-Snake® cable-guide-systems.

### Easy-Outlet-Metal

The high-quality steel versions Easy-Outlet-M were developed for entrance halls and representative rooms.

Easy-Outlet M is available in different surfaces, matt and glossy with a radial-twist-structure.

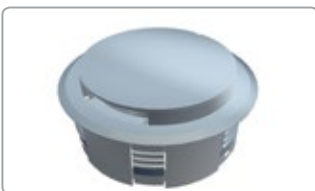

Easy-Outlet-TA for guiding single cables



Easy-Outlet-I, Connection 1x Cable-Snake®



Easy-Outlet-Quadro



Easy-Outlet-Switch

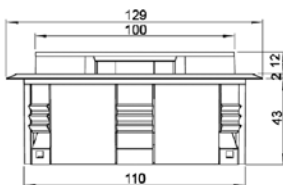

**Easy-Outlet-TA** Telescope outlet (without connection Cable-Snake®)

**Easy-Outlet-I** for 1x Cube, Cube MX, Pro, Classic, Flex, Flex II

**Easy-Outlet-II** Connection for 2x Cube, Pro, Classic, Flex, Flex II

**Easy-Outlet-Quadro** Connection for 1x Cable-Snake® Quadro

**Easy-Outlet-Premium** Connection for 1x Cable-Snake® Premium

**Easy-Outlet-Switch** Connection for 3x Cube, Pro, Classic, Flex, Flex II

**Easy-Outlet** only socket-outlet without lid

E-OUT-TA

E-OUT-I

E-OUT-II

E-OUT-QUA

E-OUT-PRE

E-OUT-SWI

E-OUT

compatible with Cable-Snake

☒ Cube ☒ Cube MX ☒ Pro ☒ Classic ☒ Flex ☒ Flex II ☒ Quadro ☒ Premium

Colors ☒ black ☒ silver ☒ light-grey ☒ white ☐ translucent

# Easy-Cover

## System-connection to ceilings

**Cable-Snake®**  
Professional Cablemanagement

### Ceiling outlet with force introduction into the plasterboard ceiling.

For connecting a Cable-Snake® cable chain to a plasterboard ceiling the stable "POM version" of Easy-Cover is used. Minor forces exerted on the cable chain are transmitted directly into the suspended ceiling, whose loading capacity has to be checked. The slot to insert the cable can be closed by inserts.

The elastic clamps on the back, fix the Easy-Cover in drilling depths from 1 mm to 30 mm.

Depending on the version up to 2x Cable-Snake® Cube, Pro, Classic, Flex, Flex II, 1x Cube MX, Premium or Quadro are connectable.

Thickness suspended ceiling  
**1 mm to 30 mm.**



Mounting on plasterboard-ceiling

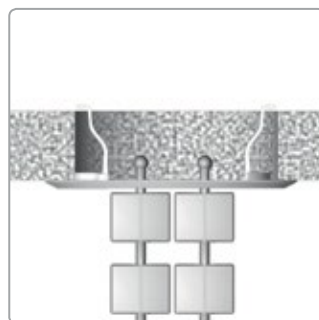

2x Cable-Snake® Cube, Easy-Cover-II

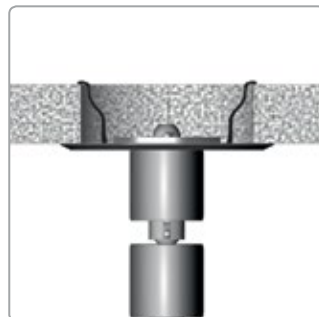

Application of force at plasterboard-ceiling up to 30 mm

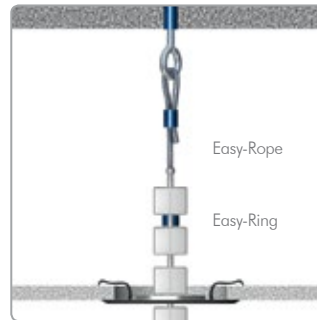

Mounting with tension rope on raw-ceiling

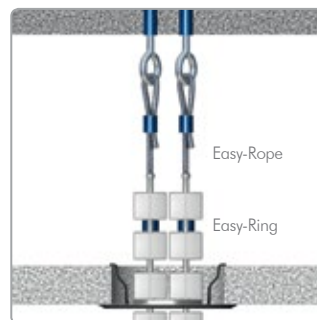

Mounting 2x KS Cube on raw-ceiling

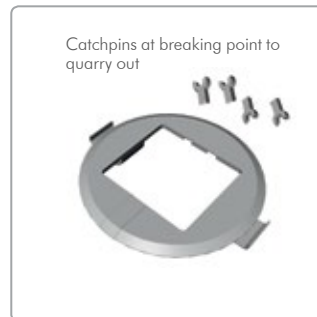

Easy-Cover without application of force into the ceiling

### Ceiling outlet with force introduction into the raw ceiling.

Pulling forces acting on the Cable-Snake® using the pull rope Easy-Rope transfer directly into the raw-ceiling. Corresponding dowels are embedded in the concrete ceiling and connected to the tension-rope.

On the tension-rope between the links of the Cable-Snake® at a distance of about 50 cm, collars Easy-Ring are installed and the power is transferred from the cable chain to the tension-rope and into the raw-ceiling.

By separating the catchpins at the predetermined breaking points, Easy-Cover is used as a "purely cosmetic cover" (PP-version).

An overload of the suspended ceiling is impossible.

Thickness suspended ceiling:  
**1 mm to „endless“.**



Easy-Cover-I



Easy-Cover-II



Easy-Cover-Quadro



Easy-Cover-Premium

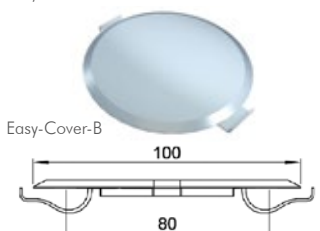

Easy-Cover-B

**Easy-Cover-B Blankcover**, Polypropylen white

**Easy-Cover-I** Connection 1x Cube, Cube MX, Pro, Classic, Flex, Flex II E-COV-I

**Easy-Cover-II** Connection 2x Cube, Pro, Classic, Flex, Flex II E-COV-II

**Easy-Cover-Quadro** Connection 1x Cable-Snake® Quadro E-COV-QUA

**Easy-Cover-Premium** Connection 1x Cable-Snake® Premium E-COV-PRE

Material: PP at mounting on a raw-ceiling. POM white for friction-locked mounting on a plasterboard-ceiling.

E-COV-B

E-COV-I

E-COV-II

E-COV-QUA

E-COV-PRE

compatible with Cable-Snake

☒ Cube ☒ Cube MX ☒ Pro ☒ Classic ☒ Flex ☒ Flex II ☒ Quadro ☒ Premium

Colors  
☒ black ☒ silver ☒ light-grey ☒ white ☐ translucent

## Easy-Clip

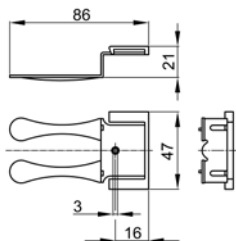

Easy-Clip simply insert into the cable-outlet

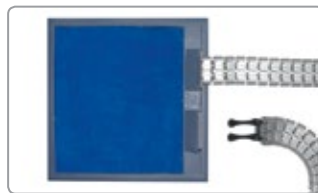

Perfect, flexible and safe connection



Compatible to all common floor-outlets

### Easy-Clip

Flexible floor-outlet-adapter compatible to all common floor-outlets.

With the achievement of higher forces, for example by kicking, the clip releases without any defect out of the floor-outlet and can easily remounted.

Easy-Clip-S, L=86mm, B=47mm for KS Classic, Flex, Flex II

E-CLI-S

Easy-Clip-L, L=91,5mm, B=51mm for KS Cube, Cube MX, Pro

E-CLI-L

compatible with Cable-Snake

☒ Cube ☒ Cube MX ☒ Pro ☒ Classic ☒ Flex ☒ Flex II ☐ Quadro ☐ Premium

Colors ☒ black ☒ silver ☐ light-grey ☐ white ☐ translucent

## Easy-Floor

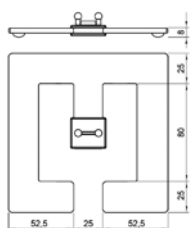
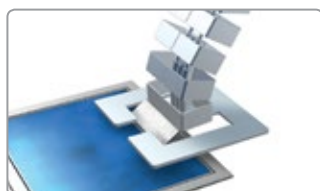

Easy-Floor-2K



Easy-Floor-1K



Easy-Floor-Premium

**Easy-Floor-2K Floor plate** steel-powder-coated 130x130 mm. Weight: approx. 350 gr. incl. 4 Bumpons.

**Easy-Floor-1K B Floor plate** steel-powder-coated 130x130 mm. Weight: approx. 350 gr. incl. 4 Bumpons.

**Easy-Floor-Premium** for Cable-Snake® Premium. 5 Bumpons & 1 screw 6 x 70 mm. Steel-powder-coated Ø=150 mm. approx. 310 gr.

Color floor-plate: black, silver-grey, white. Color adapter: black, silver, light-grey, white, translucent

E-FLO-2K

E-FLO-1K

E-FLO-PRE

compatible with Cable-Snake

☒ Cube ☒ Cube MX ☒ Pro ☒ Classic ☒ Flex ☒ Flex II ☒ Quadro ☒ Premium

Colors ☒ black ☒ silver ☒ light-grey ☒ white ☒ translucent

## Easy-Switch

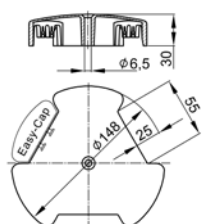

Easy-Switch junction-box with 2x Easy-Cap

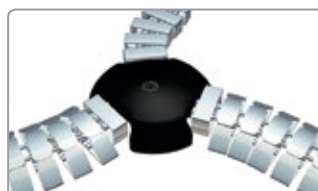

Easy-Switch-4K with 4 coupling links Cube



Easy-Switch-Premium with floor-plate

**Easy-Switch** for Cable-Snake® Cube, Classic, Flex, Flex-II.

**Easy-Switch-4K** for Cable-Snake® Pro und Cube MX. incl. 4 coupling links Cable-Snake® Cube.

**Easy-Switch-Premium** for Cable-Snake® Premium incl. floor-plate, screw and 4 coupling links Cable-Snake® Cube.

**Easy-Cap Dummy-cap** for not used connections. (also in silver!)

Please order Easy-Cap dummy-caps if required!

E-SWI

E-SWI-4K

E-SWI-PRE

E-CAP

compatible with Cable-Snake

☒ Cube ☒ Cube MX ☒ Pro ☒ Classic ☒ Flex ☒ Flex II ☐ Quadro ☒ Premium

Colors ☒ black ☐ silver ☒ light-grey ☒ white ☐ translucent

## Easy-Desk-3G

New

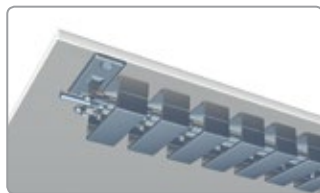
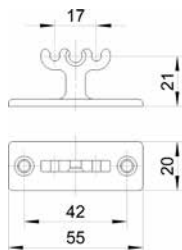

Under desk mounting as rigid cable channel I



Flexible and rigid mounting

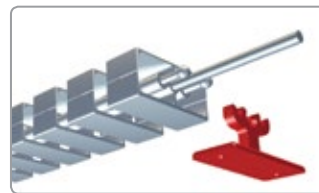

Easy-Desk-3G, Easy-Steel, Cable-Snake® Cube

### Easy-Desk-3G

Mounting-clip with catchpins for all Cable-Snakes® with 2 plug-appliances incl. 2 mounting-screws 4 x12 mm. Flexible mounting without mounting-bar. Rigid mounting with mounting-bar.

Please order Easy-Steel and Easy-Ring if required!

E-DESK-3G

compatible with Cable-Snake

☒ Cube ☒ Cube MX ☒ Pro ☒ Classic ☒ Flex ☒ Flex II ☐ Quadro ☐ Premium

☒ black ☒ silver ☒ light-grey ☒ white ☒ translucent

Colors

## Easy-Rope, Easy-Steel, Easy-Ring

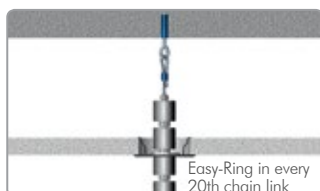

Ceiling-suspension with Easy-Rope & Easy-Ring

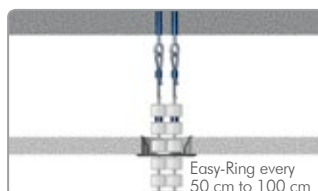

Ceiling-suspension with Easy-Rope & Easy-Ring

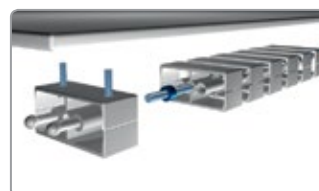

Easy-Steel for rigid mounting

**Easy-Rope** Steel-rope with transparent plastic coating.  $\varnothing = 3$  mm. Price per running meter. Depending on application up to 100 kg traction-force possible.

E-ROPE

**Easy-Steel** Mounting-bar V2A.  $\varnothing = 5$  mm, Length = 750 mm. Depending on application up to 100 kg traction-force possible.

E-STEEL

**Easy-Ring** Adjustment-ring for tension-rope and mounting-bar with adjustment-screw.

E-RING

Steel nickel-plated. Outside:  $\varnothing = 10$  mm, Inside:  $\varnothing = 5$  mm, Height=6 mm

compatible with Cable-Snake

☒ Cube ☒ Cube MX ☒ Pro ☐ Classic ☐ Flex ☒ Flex II ☐ Quadro ☒ Premium

☐ black ☒ silver ☐ light-grey ☐ white ☐ translucent

Colors

## Easy-Glue

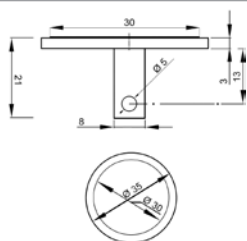

Easy-Glue, Easy-Steel, Easy-Ring, Glass-table

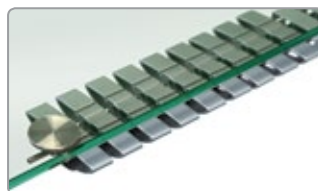

Easy-Glue, Easy-Steel glass-table mounting



Easy-Glue, Easy-Steel glass-mounting

### Easy-Glue

Stainless steel glass-mounting with radial twist-structure and high strength 3M-glue dot. Suitable for permanent bonding on glass, smooth surfaces, stone, wood, metal surfaces and (glass-) facades.

Please order Easy-Steel and Easy-Ring if required!

E-GLUE

compatible with Cable-Snake

☒ Cube ☒ Cube MX ☒ Pro ☐ Classic ☐ Flex ☒ Flex II ☐ Quadro ☒ Premium

☐ black ☒ silver ☐ light-grey ☐ white ☐ translucent

Colors

## Easy-Desk-2B

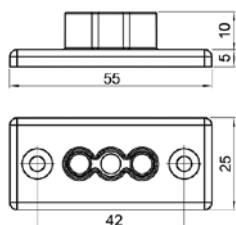

Easy-Desk-2B



Easy-Desk-2B vertical mounting on furniture

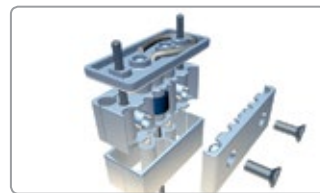

Clip fixation of tension rope Easy-Rope

### Easy-Desk-2B

Adapter for vertical mounting on furniture. Material: Polypropylen. Fine eroded surface. Incl. 2 screws: 4 x 12 mm. By using the tension-rope traction forces are transmitted safely into the table due to the patented clamping device of the adapter. Easy-Desk-2B is combinable with Easy-Stop, Easy-Steel, Easy-Rope and Easy-Connect.

### E-DESK-2B

compatible with Cable-Snake

☒ Cube ☒ Cube MX ☒ Pro ☒ Classic ☒ Flex ☒ Flex II ☐ Quadro ☐ Premium

☒ black ☒ silver ☒ light-grey ☒ white ☒ translucent

Colors

## Easy-Stop

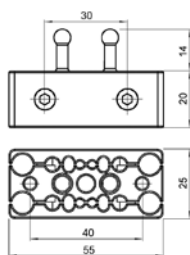

Easy-Stop with Easy-Desk-2B



Under-desk mounting

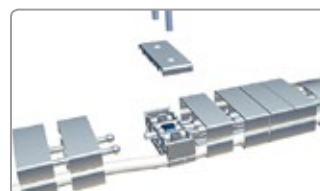

Easy-Stop strain relief up to 16 cables

### Easy-Stop

Strain relief chain link for up to 16 cables. Fits up to 4x VGA or 4x power lines, 4x network, 4x Phone, 4x ribbon cable. Strain relief incl. clamping screws (3 parts). Integrated mounting device for Easy-Ring for fixation of tension rope Easy-Rope. Easy-Stop is combinable with Easy-Desk-2B, Easy-Steel, Easy-Rope, Easy-Ring and Easy-Connect.

### E-STOP

compatible with Cable-Snake

☒ Cube ☒ Cube MX ☒ Pro ☒ Classic ☒ Flex ☒ Flex II ☐ Quadro ☐ Premium

☒ black ☒ silver ☒ light-grey ☒ white ☒ translucent

Colors

## Easy-Fix

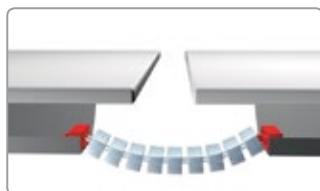
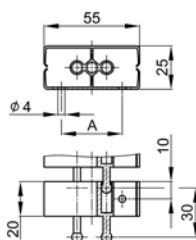

Suitable for bridging of cable channels

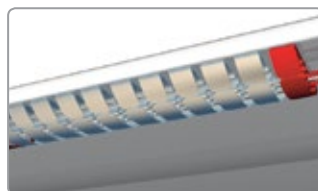

Easy-Fix-Pro with mounting bar Easy-Steel



Easy-Fix fixing-chain-links

**Easy-Fix** Chain link with mounting holes  $\varnothing=4$  mm.

**Easy-Fix-Cube** Hole spacing A = 30 mm

**Easy-Fix-Cube MX** Hole spacing A = 40 mm

**Easy-Fix-Pro** Hole spacing A = 44 mm

**Easy-Fix-Classic** 1 Hole in center

**Easy-Fix-Flex** Hole spacing A = 35 mm

**Easy-Fix-Flex-II** Hole spacing A = 30 mm

**Easy-Fix-Quadro** Hole spacing A = 25 mm

E-FIX-CUB

E-FIX-CMX

E-FIX-PRO

E-FIX-CLA

E-FIX-FLE

E-FIX-FLE-II

E-FIX-QUA

compatible with Cable-Snake

☒ Cube ☒ Cube MX ☒ Pro ☒ Classic ☒ Flex ☒ Flex II ☒ Quadro ☐ Premium

☒ black ☒ silver ☒ light-grey ☒ white ☒ translucent

Colors

## Easy-Desk-1B, Easy-Desk-1K



Easy-Desk-1B  
Ø=19 x 20 mm



Easy-Desk-1K

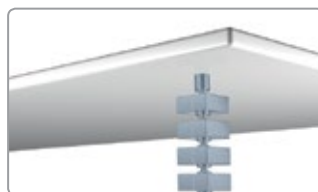

Easy-Desk-1B



Easy-Desk-1K

E-DESK-1B

E-DESK-1K

### Easy-Desk-1B

Desk fixture with hole for Cable-Snake® Quadro und Premium.  
Including screw: 4x12 mm

### Easy-Desk-1K

Desk fixture with spherical-head for Cable-Snake® Quadro und Premium.  
inkl. 2 screws: 4 x 12 mm

compatible with Cable-Snake

☐ Cube ☐ Cube MX ☐ Pro ☐ Classic ☐ Flex ☐ Flex II ☒ Quadro ☒ Premium

☒ black ☒ silver ☒ light-grey ☒ white ☒ translucent

Colors

## Easy-Connect

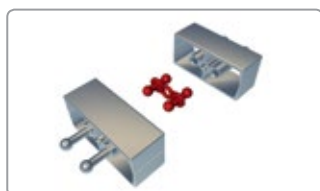
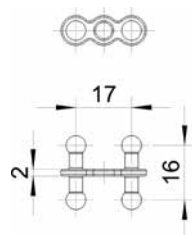

Easy-Connect, Cable-Snake® Cube

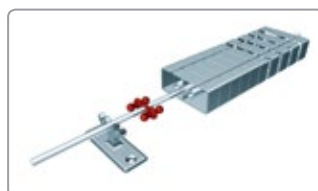

Easy-Desk-3G, Easy-Connect, Easy-Steel

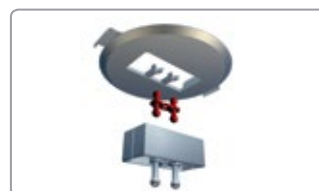

Easy-Cover-I, Easy-Connect, Cable-Snake®

### Easy-Connect

The universal socket Easy-Connect enables the direction-independent connection of almost all Cable-Snake® system-components when they are placed back to back. Easy-Connect is compatible with all flat Cable-Snake® cable-chains and with accessories which have 2 plug-appliances. The middle whole with Ø=5 mm helps to guide the mounting-bar Easy-Steel, the tensionrope Easy-Rope and for fixation with a screw.

E-CON

compatible with Cable-Snake

☒ Cube ☒ Cube MX ☒ Pro ☒ Classic ☒ Flex ☒ Flex II ☐ Quadro ☐ Premium

☒ black ☒ silver ☒ light-grey ☒ white ☒ translucent

Colors

New

## Easy-Fix-90, Easy-Channel



Easy-Fix90-S on furniture edges

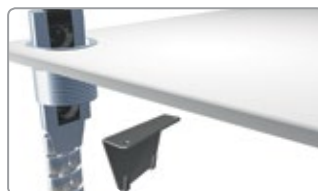

Easy-Fix-90-L for Evoline Port



Easy-Channel for table-cable channel

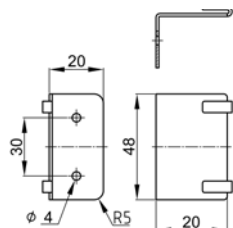

**Easy-Fix Mounting-bracket** steel,coated.

**Easy-Fix-90-S Bracket** for vertical mounting.

**Easy-Fix-90-L Bracket** for connection to Evoline-Port.

**Easy-Channel Bracket** for connection on desk-cable-channel.

E-FIX-90-S

E-FIX-90-L

E-CHA

compatible with Cable-Snake

☒ Cube ☒ Cube MX ☒ Pro ☒ Classic ☒ Flex ☒ Flex II ☐ Quadro ☐ Premium

☒ black ☒ silver ☐ light-grey ☐ white ☐ translucent

Colors

## Easy-Duct



Easy-Duct stainless steel optic



Easy-Duct black



Easy-Duct silver

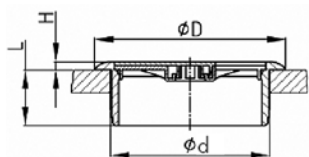

**Easy-Duct Metal** cable duct for furniture  
Stainless steel optic  $\text{ØD}=66,0$   $H=1,3$   $L=22,0$   $\text{Ød}=59,0+1$

E-DUCT-60M22-V2A

**Easy-Duct Plastic** cable duct for furniture  
black,  $\text{ØD}=67,8$   $H=2,0$   $L=16,0$   $\text{Ød}=60,0$   
silver,  $\text{ØD}=67,8$   $H=2,0$   $L=22,0$   $\text{Ød}=60,0$

E-DUCT-60K16-sz  
E-DUCT-60K22-si

compatible with Cable-Snake

☒ Cube ☒ Cube MX ☒ Pro ☒ Classic ☒ Flex ☒ Flex II ☒ Quadro ☒ Premium

Colors

☒ black ☒ silver ☒ light-grey ☒ white ☒ stainless steel

## Easy-Tape



Easy-Tape-H

Easy-Tape-D



Easy-Tape-H & Easy-Tape-S solvable fixation



Easy-Tape-H for slip on safety on carpet



Punch piece fixing Cable-Snake® on socket



Easy-Tape. B=25 mm.

**Easy-Tape-H** self adhesive 3M-velcro strip for fixation on carpet.

**Easy-Tape-S** self adhesive 3M-loop strap for detachable "bonding"

Easy-Tape-S only together with velcro strip for detachable fixation.

=>Please order same quantity of velcro strip! Running meter. B=25 mm.

**Easy-Tape-HS-50/16** Self adhesive double-punch piece H&S for detachable velcro mounting of single Cable-Snake®-links. 16x50 mm.

**Easy-Tape-D** 3M-Double-sided-tape. Width 15 mm. Price per running meter.

E-TAPE-H-25

E-TAPE-S-25

E-TAPE-ST-50x16

E-TAPE-DK-10

compatible with Cable-Snake

☒ Cube ☒ Cube MX ☒ Pro ☒ Classic ☒ Flex ☒ Flex II ☒ Quadro ☒ Premium

Colors

☒ black ☐ silver ☐ light-grey ☐ white ☐ translucent



### Guarantee of quality

We guarantee the highest quality to the latest technical standards. There is a 2 year guarantee on all appropriate mounted Cable-Snake® installation systems in office environments.

### Environmental protection

We exclusively use high quality polymers which are free of toxins according to the EU guidelines 2002/95 RG. All materials are free of PAK and Fluorine. All materials are 100% recyclable. Our certifications and accreditations can be downloaded at [www.Q-LAB.de](http://www.Q-LAB.de).

### Certification

Our production plant is certified according to DIN-ISO-9001. You will find our current certificates at [www.Q-LAB.de](http://www.Q-LAB.de).

### National and international property rights

Patents and patent applications (DE, EU)	DE 4428680, DE 19738716, DE 19963118, DE 19963119, DE 102006030086, DE 102006030426, DE 102007038577, DE 102007038608, DE 102008014382, DE 102007038577, DE 102009029957, DE 102010026553, DE 102010007581, DE 102010007580, DE 102011011639, DE 102011108848, DE 102011108849, DE 102012005534, DE 102012006945, DE 102012010454, DE 102012015546, EP 12155680
Utility patents (DE)	DE 20320850, DE 20320849, DE 20317827, DE 202004011695
Registered designs (DE)	DE 40307490, DE 40700743
Registered designs (EU)	CD 001554288, CD 001900507, CD 001970484, CD 001979352, CD 002102012
Trade Marks (DE, EU)	DE 30140018, CMT 010411833, CMT 010411841, CMT 008621146, CMT 11000718

**Cable-Snake®** is a registered trademark of the company Q-LAB®.

Cable-Snake® and Q-LAB® are registered trademarks of the company Q-LAB®.

All rights Q-LAB®.

Changes, errors and misprints are reserved.

Reproduction, also as a print-out, only with the written approval of the company Q-LAB®.

© 1994-2013



***[www.parengineering.com](http://www.parengineering.com)***



**Cable-Snake<sup>®</sup>**  
*Professional Cablemanagement*

PAR Engineering (MK) LTD  
Telephone: 01908 510822  
Website: [www.parengineering.com](http://www.parengineering.com)  
E-mail: [askpar@parengineering.com](mailto:askpar@parengineering.com)